

GENERAL NOTES

- THIS SURVEY WAS COMPLETED WITH OUT THE BENEFIT OF A CURRENT TITLE REPORT. EASEMENTS MAY EXIST ON THE PROPERTY THAT ARE NOT SHOWN HEREON.
- INSTRUMENTATION FOR THIS SURVEY WAS A 3-SECOND LEICA VIVA TS15 SMART POLE TOTAL STATION/RTK GPS.
- PROCEDURES USED IN THIS SURVEY MEET OR EXCEED STANDARDS SET BY WAC 332-130-090. SURVEY WAS COMPLETED BY A FIELD TRAVERSE.
- THE INFORMATION ON THIS MAP REPRESENTS THE RESULTS OF A SURVEY MADE ON THE DATE BELOW AND CAN ONLY BE CONSIDERED AS INDICATING THE GENERAL CONDITIONS EXISTING AT THAT TIME.
- UTILITIES SHOWN ON THIS SURVEY ARE BASED UPON ABOVE GROUND OBSERVATIONS, UTILITY LOCATES BY THIRD PARTIES, AND AS-BUILT PLANS WHERE AVAILABLE. ACTUAL LOCATIONS OF UNDERGROUND UTILITIES MAY VARY AND UTILITIES NOT SHOWN ON THIS SURVEY MAY EXIST ON THIS SITE.
- ALL MONUMENTS WERE LOCATED DURING THIS SURVEY UNLESS OTHERWISE NOTED.
- CONTOURS SHOWN ARE BASED ON A FIELD SURVEY.
- TREE IDENTIFICATION WAS PERFORMED BY SURVEY FIELD PERSONNEL AND SHOULD BE CONSIDERED A BEST GUESS. AN ARBORIST SHOULD BE RELIED UPON FOR MORE ACCURATE AND DETAILED IDENTIFICATION OF TREE SPECIES AND HEALTH.

LEGAL DESCRIPTION
 LOT 22, LAKEMONT WOODS DIVISION I, ACCORDING TO THE PLAT THEREOF RECORDED IN VOLUME 140 OF PLATS, PAGES 1-3, RECORDS OF KING COUNTY WASHINGTON.
 SITUATE IN THE CITY OF BELLEVUE, COUNTY OF KING, STATE OF WASHINGTON.

BASIS OF BEARINGS
 PER THE PLAT OF LAKEMONT WOODS DIVISION I, ACCORDING TO THE PLAT THEREOF RECORDED IN VOLUME 140 OF PLATS, PAGES 1-3, RECORDS OF KING COUNTY WASHINGTON.
 ACCEPTED THE BEARING OF N 13°42'32" E FOR 160TH AVE SE BASED ON FOUND MONUMENTS IN CASE.

VERTICAL DATUM & CONTOUR INTERVAL
 ELEVATIONS SHOWN ON THIS DRAWING ARE BASE ON THE NORTH AMERICAN VERTICAL DATUM OF 1988 (NAVD88) AND WERE ESTABLISHED USING RTK GPS.
 1.0' CONTOUR INTERVAL - THE EXPECTED VERTICAL ACCURACY IS EQUAL TO 1/2 THE CONTOUR INTERVAL OR ± 0.5' FOR THIS PROJECT.

PROJECT INFORMATION
 SURVEYOR: PLOG REAL ESTATE AND CONSULTING, LLC, 22525 SE 64TH PL, STE 2274 ISSAQUAH, WA 98027 PH.: (206) 420-7130
 PROPERTY OWNER: LISA AND JAY CLEM 6133 160TH AVE SE BELLEVUE, WA 98006
 TAX PARCEL NUMBER: 4139900220
 PROJECT ADDRESS: 6133 160TH AVE SE BELLEVUE, WA 98006
 PARCEL AREA: 33,330 S.F. (0.765 ACRES ±) AS SURVEYED

SE1/4, SE1/4, SEC 23, TWP 24N, RNG 05E, W.M.
BOUNDARY & TOPOGRAPHIC SURVEY
JAY & LISA CLEM
 6133 160TH AVE SE, BELLEVUE, WA
 PROJECT NO.: 014-18 REVISION DATE: 03/02/2018 REVISION NO.: 0 SHEET: 1 OF 1

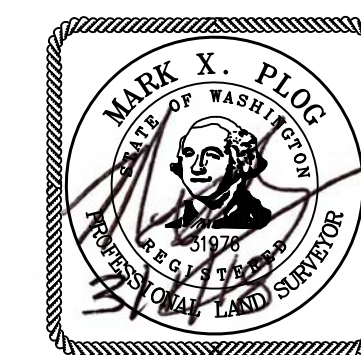

PLOG
 REAL ESTATE AND CONSULTING
 Surveying - Engineering - Real Estate

22525 SE 64th Place
 Suite 2274
 Issaquah, WA 98027
 (206) 420-7130
 plogrealestate.com